



**KBC1**

Dimensions (mm)	External	Internal
Height	900	
Width	600	
Depth	520	
Capacity (L)		
Gross		138
Net		135BTL



**KBC2**

Dimensions (mm)	External	Internal
Height	900	
Width	900	
Depth	520	
Capacity (L)		
Gross		218
Net		202BTL



**KBC2SL**

Dimensions (mm)	External	Internal
Height	900	
Width	900	
Depth	520	
Capacity (L)		
Gross		218
Net		202BTL



**KBC3**

Dimensions (mm)	External	Internal
Height	900	
Width	1350	
Depth	520	
Capacity (L)		
Gross		338
Net		338BTL



**KBC3SL**

Dimensions (mm)	External	Internal
Height	900	
Width	1350	
Depth	520	
Capacity (L)		
Gross		338
Net		338BTL

## Features

- Black exterior with aluminium interior
- Self-closing double glazed door (s)
- 2 adjustable shelves per door
- Fitted locks
- Internal LED illumination with on/off switch
- Adjustable feet

## Additional Extras

- K8-SHELF - Shelf for KBC1
- K8-SHELF01 - Shelf for KBC2(SL) and KBC3(SL)
- K8-GASKET01 - Door gasket for KBC1
- K8-GASKET02 - Door gasket for KBC2 and KBC3
- K8-SHELFCLIPN - Shelf clip (4 required per self)



## Technical Specification

	KBC1	KBC2	KBC2SL	KBC3	KBC3SL
Temperature Range	+4°C ~ +10°C	+4°C ~ +10°C	+4°C ~ +10°C	+4°C ~ +10°C	+4°C ~ +10°C
Climate Class	4	4	4	4	4
Power Supply	13amp	13amp	13amp	13amp	13amp
Cooling	Fan assisted	Fan assisted	Fan assisted	Fan assisted	Fan assisted
Defrost	Automatic	Automatic	Automatic	Automatic	Automatic
Noise Level	49db	66db	67db	58db	58db
Refrigerant	R600a	R600a	R600a	R600a	R600a
Energy Efficiency Class	F	F	F	F	F
Energy Consumption (kw/24hrs)	1.86	2.04	2.04	3.60	3.60
Power Usage (w)	585	990	1011	1225	1260
Weight (kg)	47	73	73	89	89

### KBC1

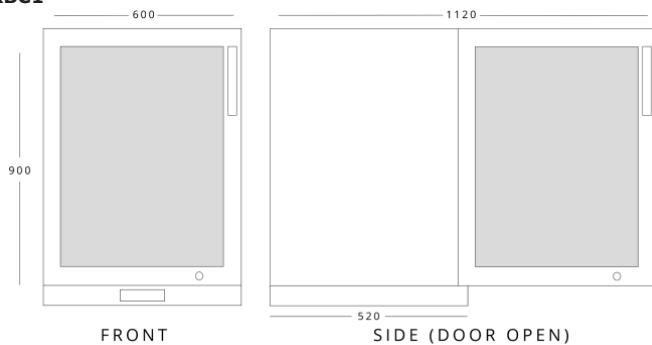

### KBC2

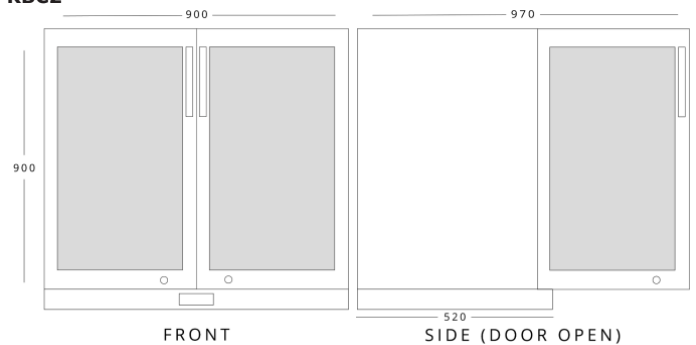

### KBC2SL

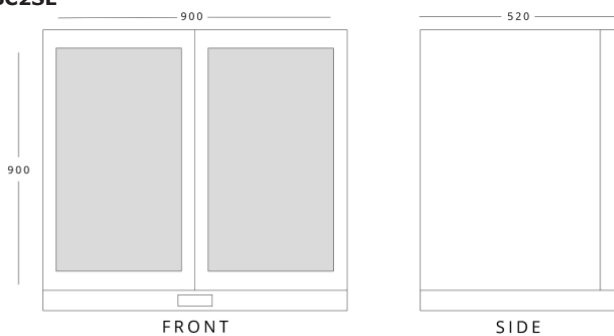

### KBC3

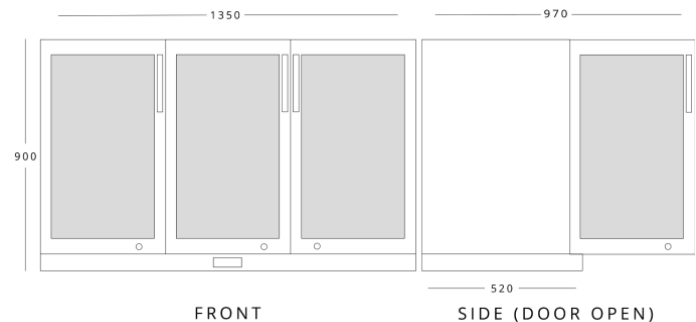

### KBC3SL

